

0/002 Public Library

- Making good to ceiling finishes where 0/007 & 0/009 have been removed.
- New carpet tiles where 0/007 & 0/009 have been removed.
- New pinboard surrounds to 6nr piers.
- New Reception area along North wall.

Generally

- Renew decoration throughout building.

Externally

- New aluminium framed curtain walling to all elevations.
- New aluminium framed doors to all elevations.
- New aluminium framed windows to all elevations.



0/007 Plant Room

- Existing arrangement to remain.

0/006 Office

- New doorset to 0/002.
- Relocate switches electrics to suit opening of door.
- 2nr cupboards retained.
- New carpet.

0/006A Staff WC

- New suspended ceiling grid.
- New internal partition system.
- New doorset to 0/003.
- New half height wall tiling, with decoration above.
- New vinyl floor finishes.
- New concealed cistern WC, cistern casing and wash hand basin.
- New window extract.
- New infill panel witin high level window reveal at end of partition.
- Connect into existing below ground drainage.

0/004 WC

- New suspended ceiling grid.
- New internal partition system.
- New internal door.
- New half height wall tiling, with decoration above.
- New vinyl floor finishes.
- New concealed cistern WC, cistern casing and wash hand basin.
- New window extract.

0/005 WC

- New suspended ceiling grid.
- New internal partition system.
- New internal door.
- New half height wall tiling, with decoration above.
- New vinyl floor finishes.
- New concealed cistern WC, cistern casing and wash hand basin.
- New window extract.

0/003 Lobby

- New suspended ceiling grid.
- New entrance matting.
- Decoration
- Alteration required to fire exit door ironmongery.

Ground Floor Level

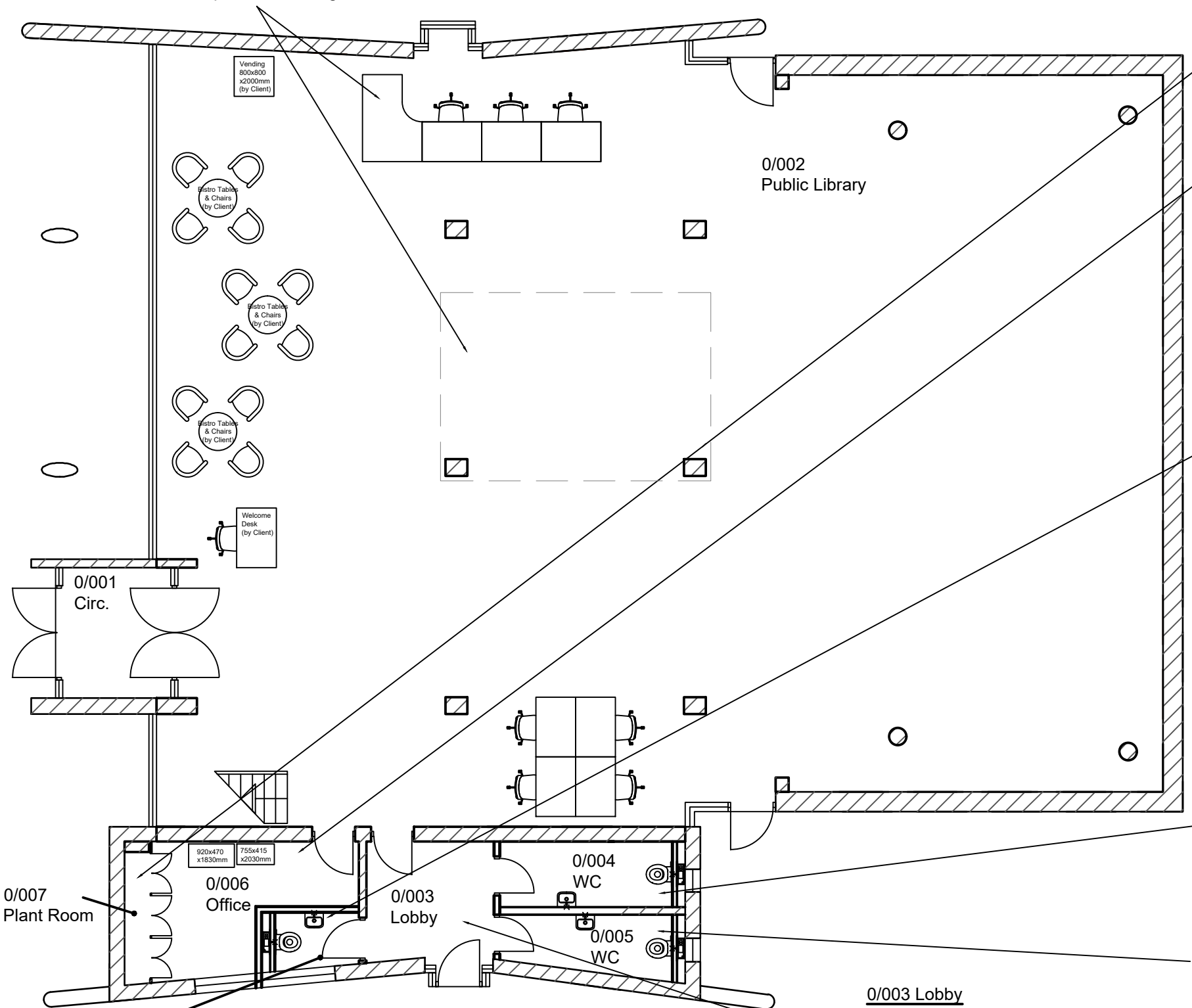

Notes

Bailey Partnership is the trading name of Bailey Partnership (Consultants) LLP, a limited liability partnership registered in England and Wales No.- OC420278.

This drawing is copyright and owned by Bailey Partnership (Consultants) LLP, and is for use on this project and site only unless contractually stated otherwise.

DO NOT SCALE from this drawing (printed or electronic versions). Contractors must check all dimensions from site.

All other design team elements, where indicated, have been imported from the consultant's drawings and reference should be made to the individual consultant's drawings for exact setting out, size and type of component.

Discrepancies and / or ambiguities within this drawing, between it and information given elsewhere, must be reported immediately to the architect for clarification before proceeding.

All works are to be carried out in accordance with the latest British Standards and Codes of Practice unless specifically directed otherwise in the specification.

Responsibility for the reproduction of this drawing in paper form, or if issued in electronic format, lies with the recipient to check that all information has been replicated in full and is correct when compared to the original paper or electronic image. Graphical representations of equipment on this drawing have been co-ordinated, but are approximations only. Please refer to the Specifications and / or details for actual sizes and / or specific contractor construction information.

Ordnance Survey Paper Map Copying License number: 40006119

This original document is issued for the purpose indicated below and contains information of confidential nature. Further copies and circulation will be strictly in accordance with the confidentiality agreement under the contract.

© Bailey Partnership (Consultants) LLP: This document is issued for the party which commissioned it and for specific purposes connected with the captioned project only. It should not be relied upon by any other party or used for any other proprietaries. We accept no responsibility for the consequences of this document being relied upon by any other party, or being used for any other purpose, or containing any error or omission which is due to an error or omission in data supplied to us by others.

SAFETY, HEALTH AND ENVIRONMENTAL INFORMATION

Refer to the relevant Construction (Design and Management) documentation where applicable.

It is assumed that all works on this drawing will be carried out by a competent contractor, working where appropriate to an approved method statement.

00	Preliminary Issue	HC/TB/TB	29.04.2022
Rev	Description	By / Chk'd / App'd	Date



Client

Saltash Town Council

Project

Saltash Library Refurbishment

Drawing Title

Proposed Ground Floor Plan

Purpose of Issue PRELIMINARY		Status S2	
Project No. 33358	Scale @ A3 1:100	Date 29.04.2022	
Revision 00	Drawn By HC	Check By TB	Approved By TB

A3 Drawing Identifier	BS1192:2007 / Avanti Compliant
Project Origin Zone Level Type Role Class Number	
SAL BPC XX 00 DR B 061 001	

www.baileypartnership.co.uk